

Attachment # 1

DC Admin  
1512 SF

GIS  
985 SF

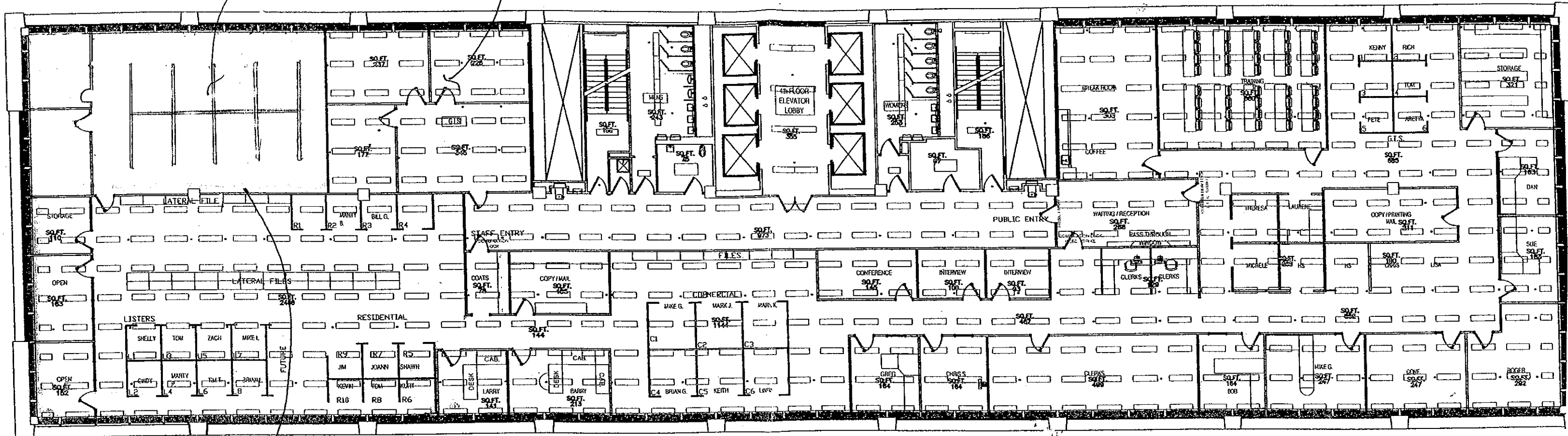

WALL IS 35 LF

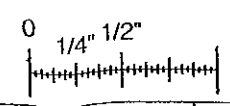

OMAHA / DOUGLAS PUBLIC BUILDING COMMISSION	Drawn By : ADAM JOHNSON	DATE : 06/07/12	CIVIC CENTER 4th FLOOR SOFT/LIGHTING/SPRINKLERS	SCALE: NONE	Commissioned By : PAT HERZOG	Approved By : _____	SHI 0
---	----------------------------	--------------------	---	----------------	---------------------------------	---------------------	----------

Tuesday, September 01, 2015  
 Administrative Services Committee

Attachment # 2

1. Request for Space on 4th Floor:			
Wall is 35 lineal foot long		35	35
		8	13
	SF	280	455

2. Discussion regarding County Attorney Space issues:			Square Footage	
County Attorney Courthouse Basement			2,200	sf
Storage remains in basement (2,300sf)				
Imaging / Records (storage remains in C Level)			1,240	sf
		Total Avail	3,440	sf
Treasurers Vacant Space			3,250	+/-

3. Discuss Strategic Planning regarding County Space needs:				
<b>Bond Projects:</b>				
-TFVH - (911 - Treasurers - Enviromental Services)			59,000.00	sf
-Juvinile Justice - ?? (Relocate out of Courthouse)			52,026.00	sf
-Correction Center - ?? (Old Side age 39 & Annex age 27)				

4. Other space issues:			Square Footage	
6th Juvnile Judge (4788sf - 2000sf = 2788sf)			4,788	sf
4th floor - Assessor / Register of Deeds			15,475	sf
4th floor - LC Administration			1,512	sf
4th Floor - GIS			1,000	sf
Work Comp Court			2,169	sf
DC County Clerk			8,156	sf
Treasurers (Harney level)			11,070	sf
Register of Deeds			6,132	sf
Adult Probation			2,643	sf